



## Macedon - 'Urban'

\$718,850

### Genuine Turnkey

**Absolutely nothing more to spend to move your family into this home!**

An impressive and unique floor plan sets the Macedon apart from the rest. Featuring four bedrooms, plus a media room, plus a well-positioned study.

The Macedon features a superb Parent's Retreat with a generous walk-in robe leading through to a spacious ensuite.

Three well-proportioned bedrooms are at the rear of the home. The open plan meals and living area are at the heart of the home, flowing to a well-appointed gourmet kitchen with walk-in butler's pantry, all looking out over the alfresco and sunlit courtyard garden, filling the home with sunshine. Plenty of room for a growing family.

When you step through the front door, you will know you have come home!

### SPECIAL Features:

- Fully ducted air conditioning
- Quality tiles and carpet to all living areas
- Quality tiles to porch and alfresco
- Polymarble bench tops to vanities
- Free standing bath
- Coloured concrete driveway





Instyle Homes  
Group Pty Ltd

Macedon

### House Details

Ground Floor	175.02 m <sup>2</sup>
Alfresco	12.38 m <sup>2</sup>
Courtyard	6.26 m <sup>2</sup>
Porch	2.39 m <sup>2</sup>
Garage	34.74 m <sup>2</sup>
House Size	230.79 m <sup>2</sup>

House Width	10.600 m
House Length	23.330 m
Minimum Block Width	12 m

### Room Sizes

Parent's Retreat	4.3 x 3.0 m
Study	3.8 x 3.0 m
Bed 2	3.0 x 2.8 m
Bed 3	3.0 x 3.0 m
Bed 4	3.0 x 2.8 m
Media	4.2 x 3.0 m
Living	7.0 x 3.0 m
Meals	5.5 x 3.6 m
Kitchen	5.5 x 3.5 m
Double Garage	6.2 x 5.5 m

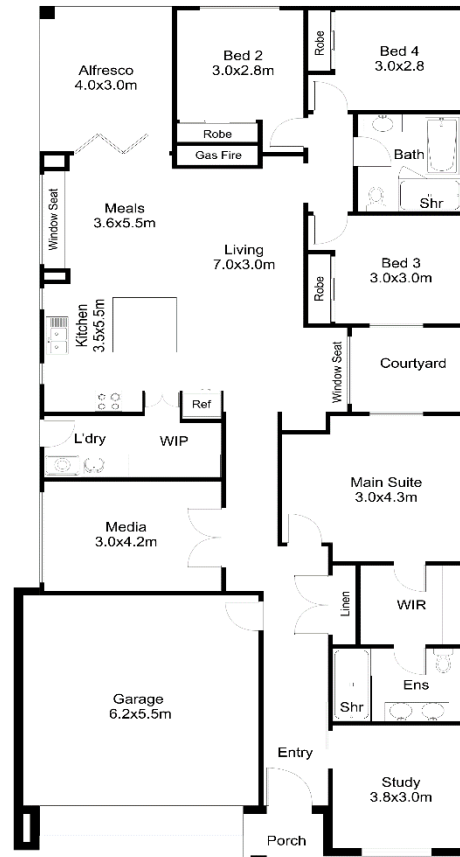

Instyle Homes Group Pty Ltd P: 02 4647 8307 | E: office@ishg.com.au | W: [www.instylehomesgroup.com.au](http://www.instylehomesgroup.com.au)

\* Important Note: Images in this brochure may depict fixtures, features or finishes not supplied by Instyle Homes Group, such as furniture, plants and landscaping. Images may also depict optional variations which incur additional costs, such as window furnishings, light fittings such as pendants and downlights, front paths, fireplaces, driveways, floor coverings, rendered external walls, stonework, and upgraded kitchen / bathroom layouts and / or finishes. Pricing may vary depending on specific design, site, BASIX requirements, final selections, and fixtures, please discuss availability and pricing with our staff.